

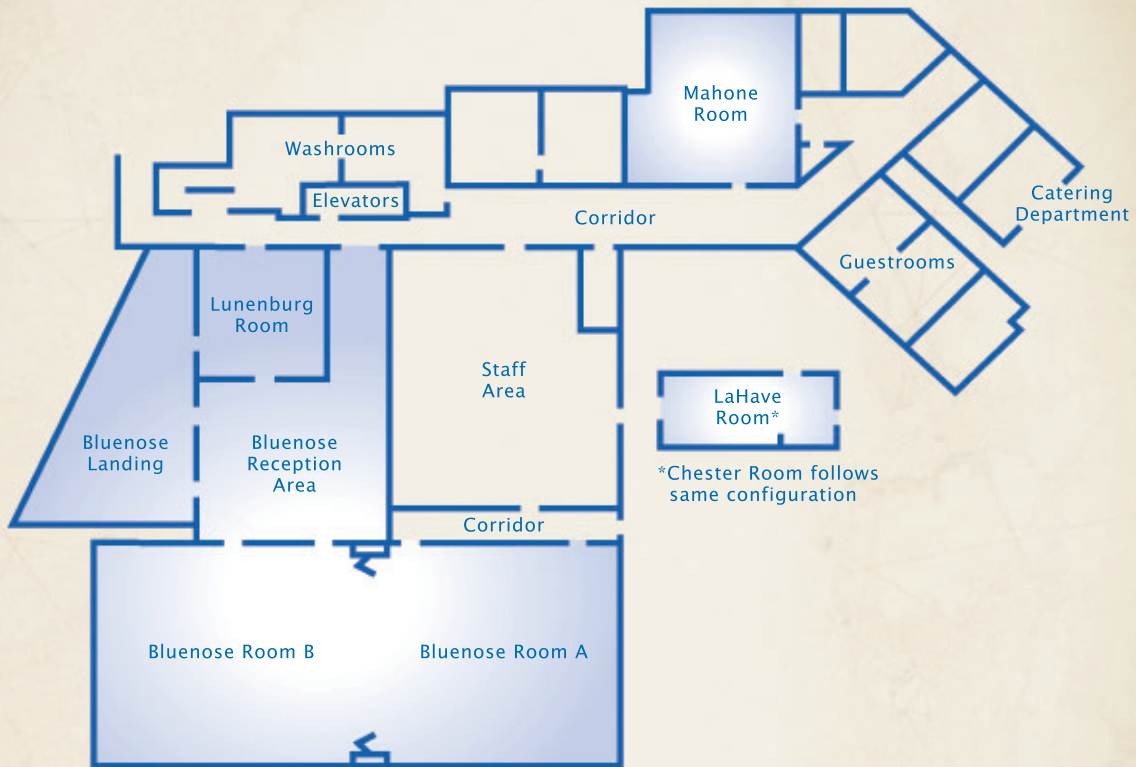

meeting rooms & facilities



	Dimensions	Sq. Feet	Ceiling Ht.	Rounds (10s)	Boardroom	U-Shape	Classroom	Hollow Square	Theatre
Bluenose Room A	47' x 46'	2162	10.8'	180	42	51	120	62	240
Bluenose Room B	47' x 46'	2162	10.8'	180	42	51	120	62	240
A & B combined	47' x 92'	4324	10.8'	360	68	68	240	96	480
Bluenose Reception Area	37' x 30'	1110	10.8'	--	--	--	--	--	--
Mahone Room	30' x 44'	1320	10'	120	28	37	81	46	120
Lunenburg Room	22' x 27'	594	10'	50	20	24	45	32	60
Chester Room	14' x 22'	308	7.10'	20	14	12	12	--	--
LaHave Room	14' x 22'	308	7.10'	20	14	12	12	--	--
Tancook Room	28 x 22'	626	7.10'	60	24	26	47	26	90

The number for all meeting configurations are shown at a maximum, without AV or food and beverage service.
The rounds are tables of ten.